

Editing an ELD Log

Before you learn how to edit you must understand that you can only edit a past status, meaning you cannot edit the status you are currently in. For example if I was on-duty all weekend I first need to select a status which will make the weekend on-duty time a past status.

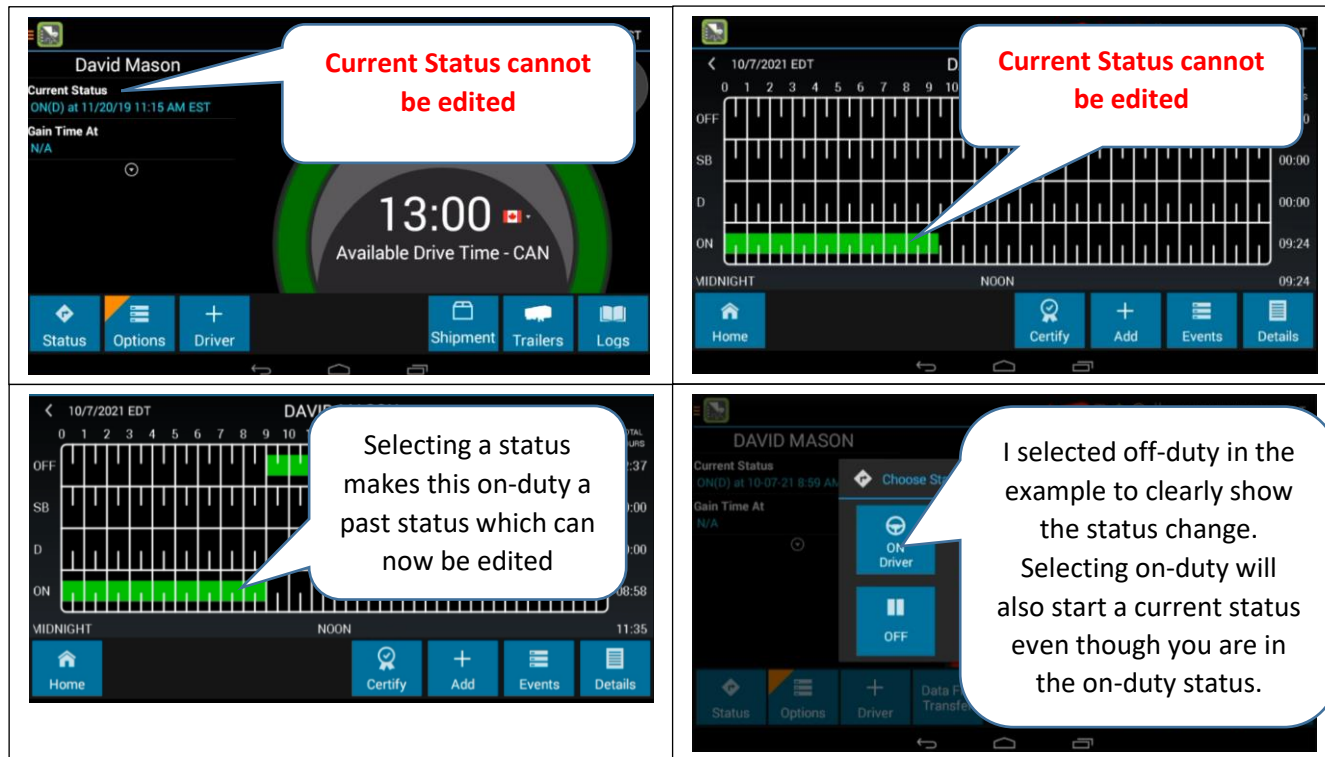

There are 2 ways to edit a log

1. An entire status on the driver's log can be edited through the "Events" screen.
2. The "Add" can be used to select a start time for the status.

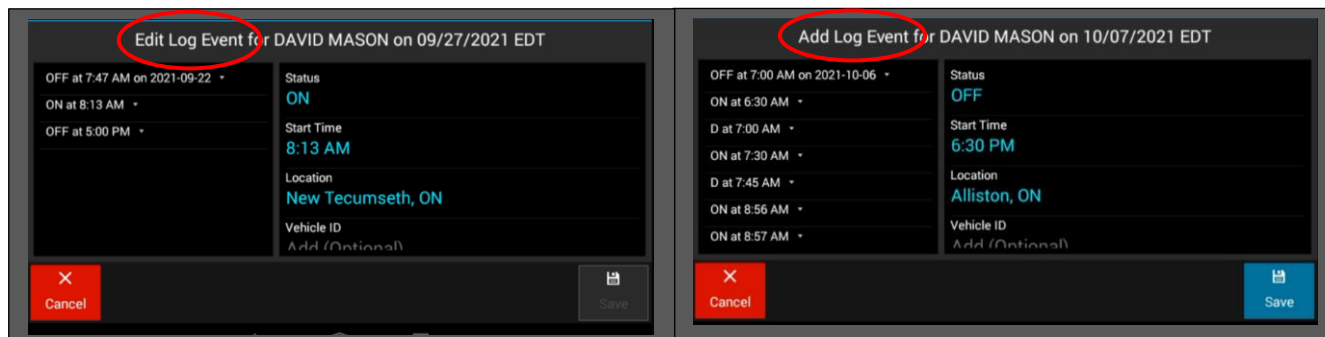
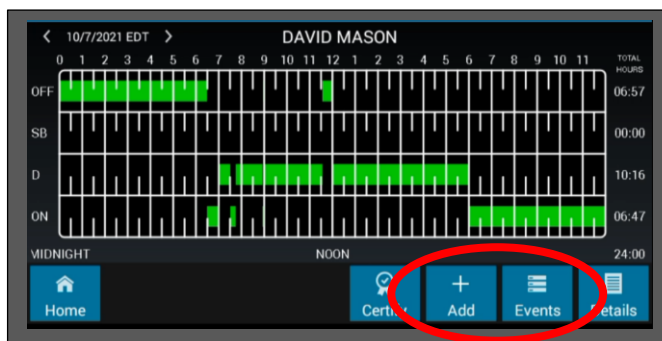

How to Edit your log using "Add"

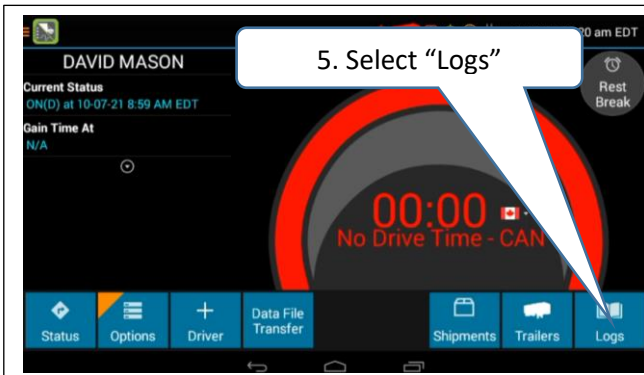
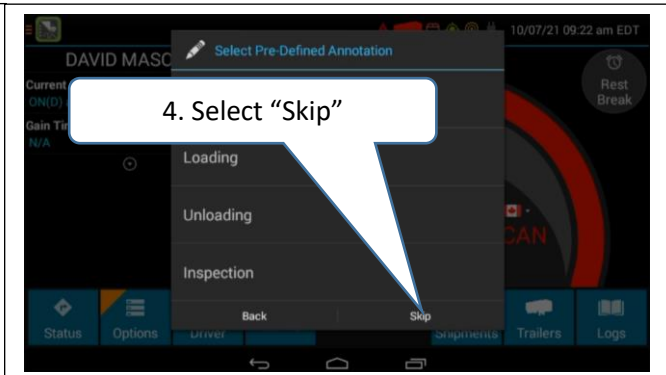
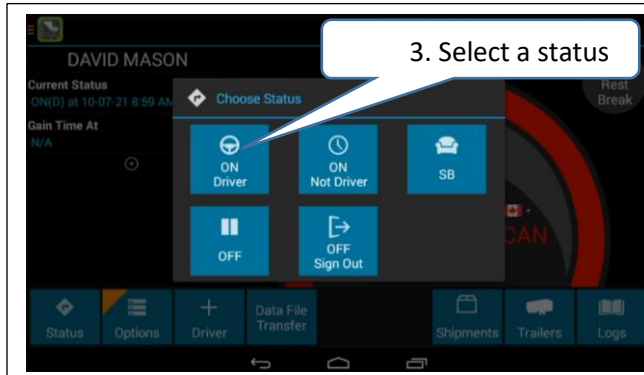
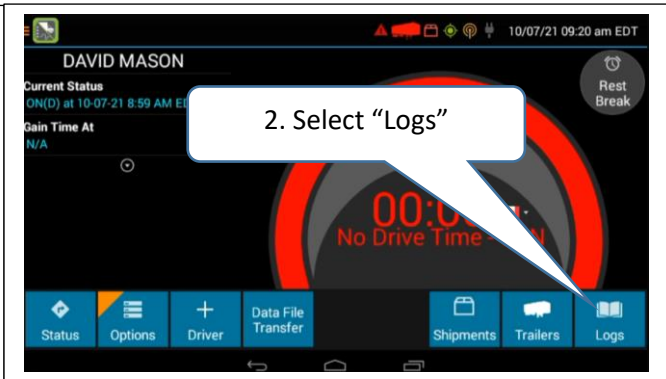

7. Enter: Status, Start Time, Location, Vehicle ID, Reason for Change.

DAVID MASON on 10/07/2021 EDT

Status Add

Start Time Add

Location Add

Vehicle ID

Reason for Change

Cancel

Enter The Location:

City: Alliston State/Province: ON

Cancel OK

Add Status

D SB ON

OFF ON YM OFF PC

PC/YM Clear

Set Start Time

5 29 AM

6 30 PM

7 31

Cancel OK

How to Edit your log using "Add" cont.

Add Log Event for DAVID MASON on 10/07/2021 EDT

7. Enter, Status, Start Time, Location, Vehicle ID, Reason for Change.

Location
Add

Vehicle ID
Add (Optional)

Reason For Change
Add

Select the truck number you were in at the time. If the same skip Vehicle ID.

+ Reason For Change
Enter an annotation for this event:
Did not log out
Cancel Submit

Cancel

Add Log Event for DAVID MASON on 10/07/2021 EDT

6:30 PM

Location
Alliston, ON

Vehicle ID
Add (Optional)

Reason For Change
Did not log out

8. Confirm you entered the correct information

Add Log Event for DAVID MASON on 10/07/2021 EDT

6:30 PM

Location
Alliston, ON

Vehicle ID
Add (Optional)

Reason For Change
Did not log out

9. Select "Save"

Cancel Save

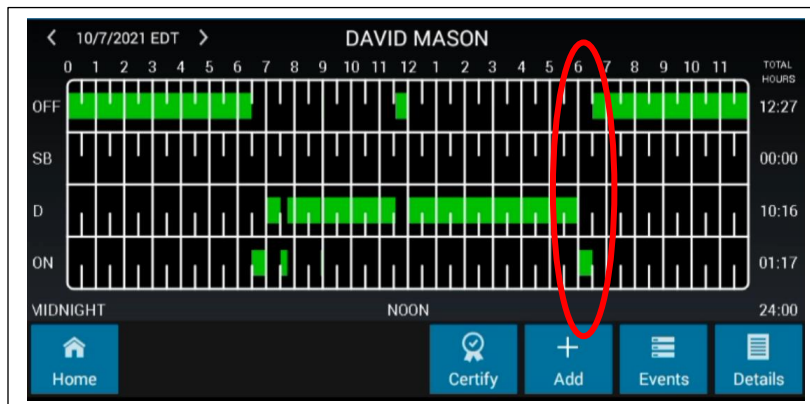

Using "Add" to edit we were able to enter the time we wanted the off-duty status to start (6:30pm) which left 30 minutes on-duty for the post trip. If we wanted to edit the entire status we would use the "Events" tab.

How to Edit an ELD log using “Events”

The following instructions we will edit an entire on-duty status 8:13am – 5:00pm to off-duty using “Events”. Start by using the same steps 1 - 5 in previous “Add” instructions.

6. Select “Events”

7. Scroll to find the status/event to edit and tap on it

8. When you tap the status it will highlight grey then select “Edit”

9. Tap Status “ON”

10. Select “OFF”

11. Tap “Reason For Change” Add

12. Tap to enter Reason for Change

13. Enter reason for change then Tap “Submit”

How to Edit an ELD log using "Events"

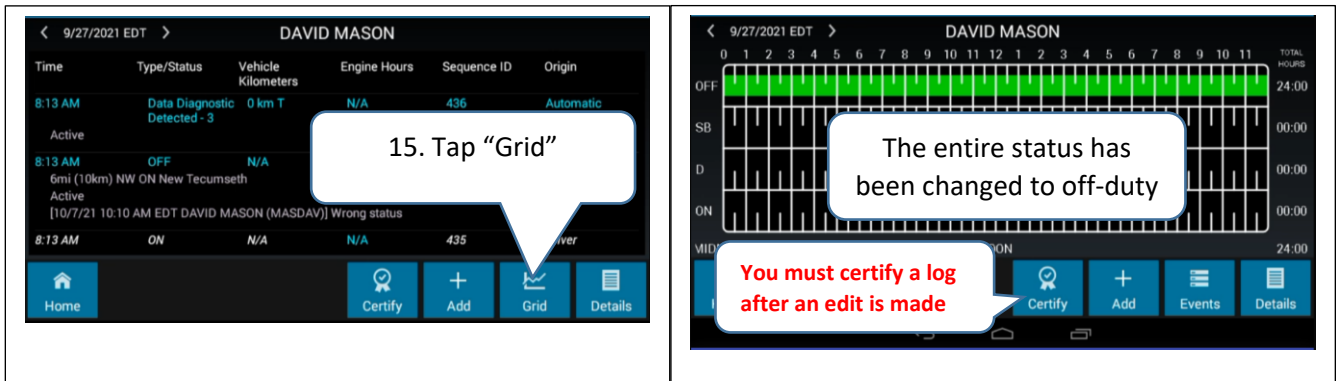
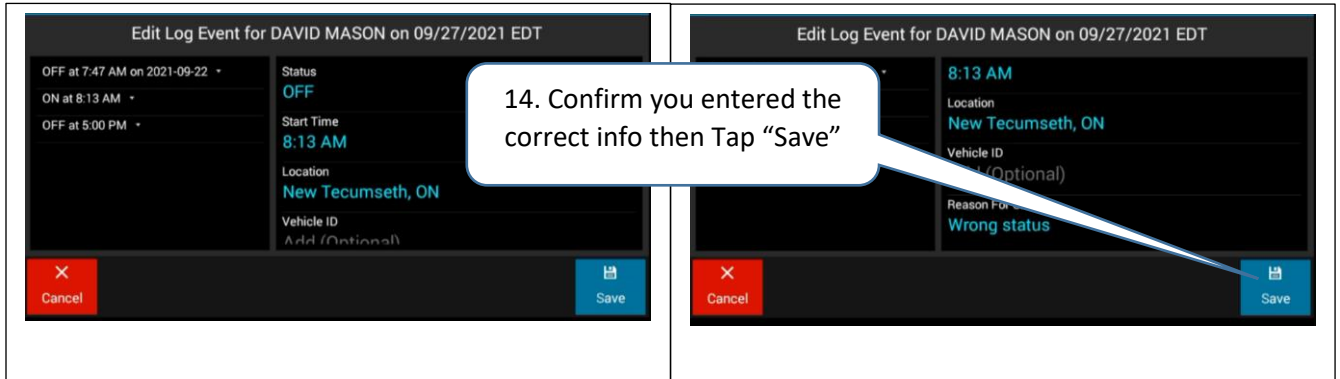

After editing a log you should "Request Logs" to synchronize the tablet with Peoplenet.

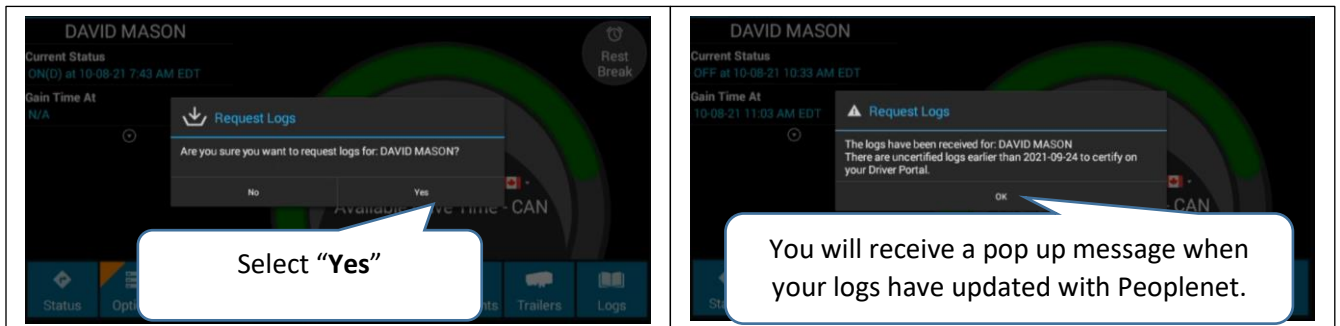
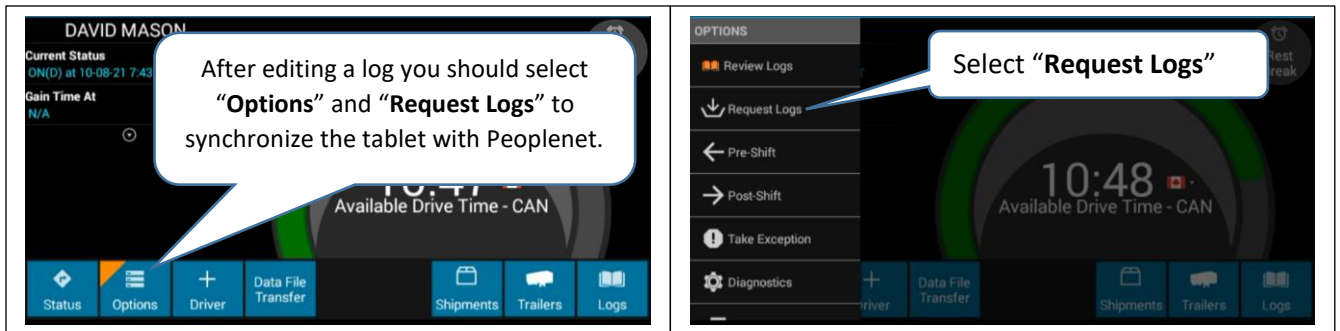

Editing an ELD Log



Logs can also be edited through the Peoplenet Drivers Portal

From the Warren Gibson Website, scroll to the bottom of the tools bar and select the

Peoplenet ELD Portal Login Link

PeopleNet ELD Portal Login: <https://www.pfmlogin.com/pfm-main/authentication/login#>

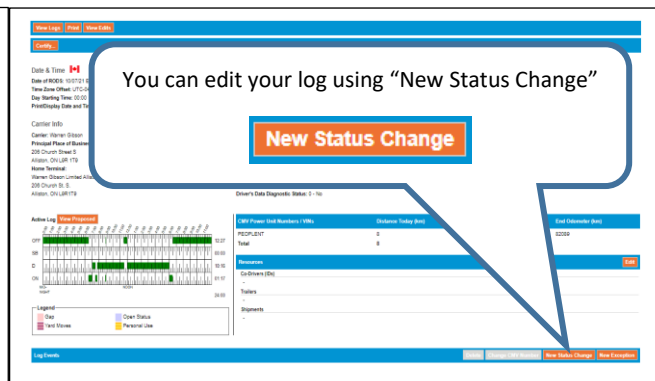
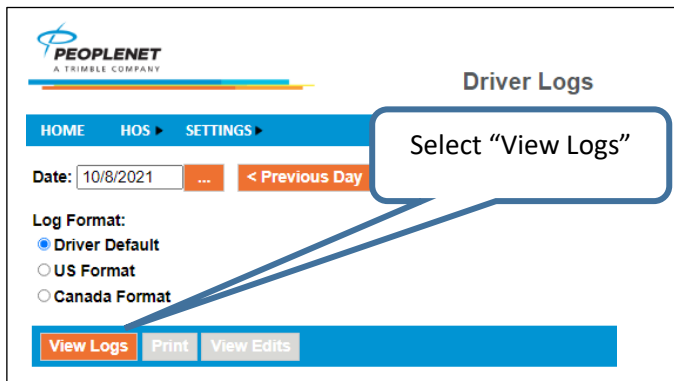
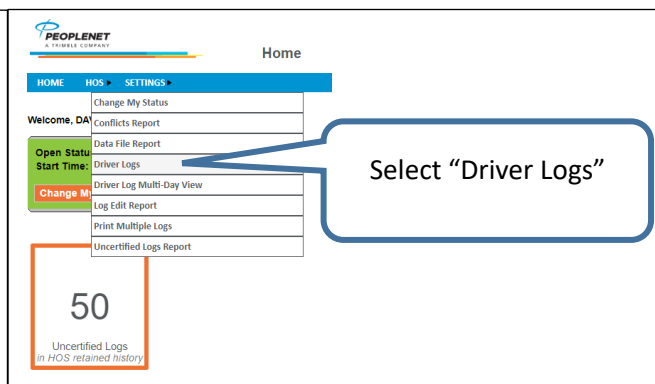
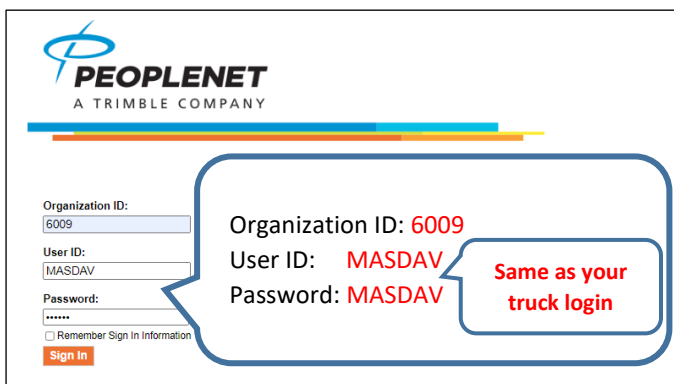

Note: All "Driver" status can be edited but an "Automatic" status can only be shortened meaning you can only use "Add" to edit an "Automatic" status.

So to edit the 8:13 am "Automatic" status below you use "Add" and enter 8:14am. This will leave a 1 minute "Automatic" status from 8:13am - 8:14am that cannot be edited and if that is a 1 minute on-duty status it may affect a shift reset or a cycle reset.

9/27/2021 EDT DAVID MASON

Time	Type/Status	Vehicle Kilometers	Engine Hours	Sequence ID	Origin
8:13 AM	Data Diagnostic Detected - 3	0 km T	N/A	436	Automatic
Active					
8:13 AM	OFF	N/A	N/A	452	Driver
Active					
[10/7/21 10:10 AM EDT DAVID MASON (MASDAV)] Wrong status					
8:13 AM	ON	N/A	N/A	435	Driver

Home Certify Add Grid Details